

# Cigar Cutter Kit



## Kit Features:

- Multiple Finishes
- Replaceable stainless steel cutter
- Easy to carry and cut cigar tips
- Spring action ejector button easily removes cigar waste
- Spare stainless steel cutter supplied
- Overall length: 3"
- Swivel key ring

## Required Accessories:

- 7mm mandrel
- 7MM drill bit
- 7MM barrel trimmer )
- Bushing set ##419 Sierra
- 2 part epoxy glue or insta-cure (cyanoacrylate)



## DIAGRAM A / PARTS LAYOUT

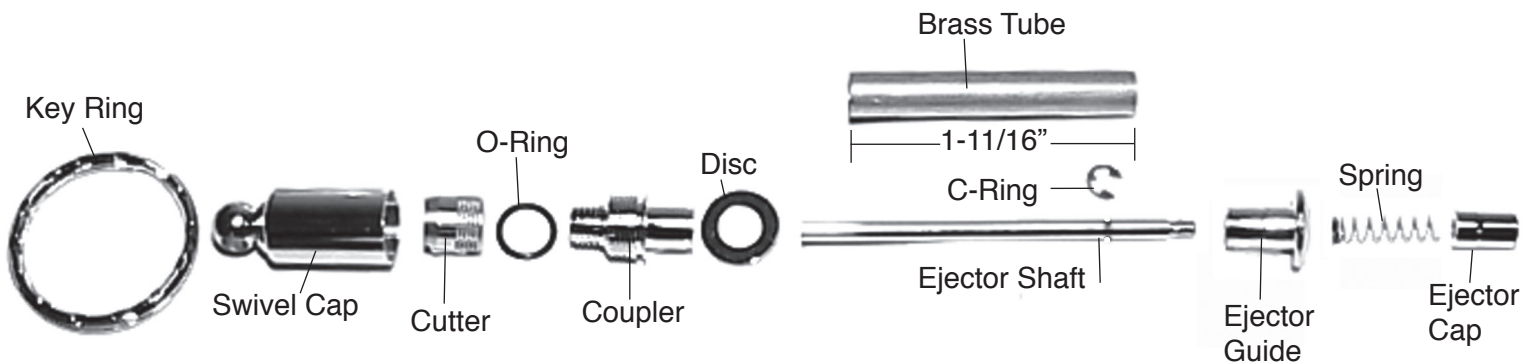

## Preparing the Blank:

- Cut a 3/4" to 5/8" square blank to the length of the brass tube (add 1/16" for squaring off).
- Drill a 7mm center hole lengthwise through the blank.
- Spread glue over the brass tube. Insert it into the blank with a twisting motion to spread the glue evenly inside.
- Center the tube lengthwise inside the blank.
- When the glue dries, square the ends of the blank. Use a 7mm barrel trimmer or a universal pen blank squaring jig to take the wood down flush square to the brass tube.

**13650 TI Blvd #101 \* Dallas, TX 75243**  
**972-669-9130 \* [www.woodworldtx@gmail.com](mailto:www.woodworldtx@gmail.com)**



**DIAGRAM B / TURNING THE BLANK**

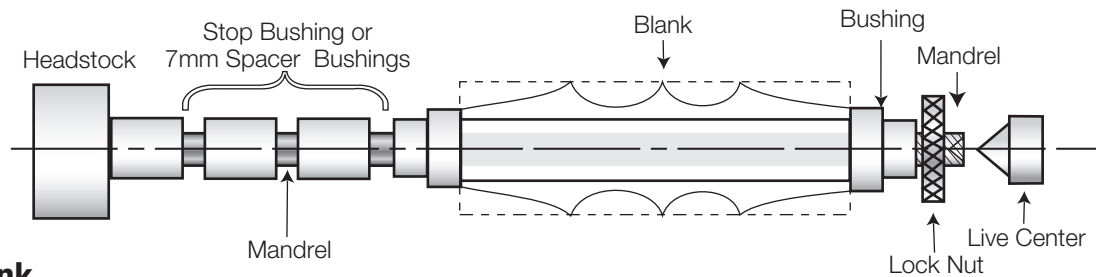

**Turning the Blank**

- Place 7MM spacer bushings on the mandrel. Then one kit bushing, large diameter facing blank. Then the wood blank, and the other bushing, large diameter facing blank. Use additional bushings to fill up the space on the mandrel. Thread on the knurled lock nut. Engage the tail stock with the live center snug into the mandrel shaft. Lock it in place (Do not over tighten, it may damage the mandrel). Hand tighten the knurled lock nut to secure the blank from spinning on the shaft.
- Turn the blank to the design of your choice. It is not necessary to turn the wood flush to meet the bushings diameter. Be creative and design your own unique cigar punch profile.

**Assembly**

- Line up parts according to Diagram 'A'.
- Place the disc over the non-threaded end of the coupler.
- Press the coupler into the cutter end of the finished barrel.
- Place the O-ring over the threads on the coupler.
- Press the C-ring into the slot in the ejector shaft.
- Insert the ejector shaft into the barrel, leaving the threaded end exposed.
- Place the ejector guide over the threads on the shaft, and press into the barrel.
- Slide the spring, closed- end first, over the thread on the shaft through the ejector guide.
- Press the threaded end of the shaft halfway in, and grab the opposite end gently with a pair of pliers.
- While holding end in the pliers, screw on the ejector cap hand tight compressing the spring.
- Thread the cutter, hand tight, on the exposed coupler.
- Insert the key ring into the hole in the swivel cap, and thread it onto the cutter assembly.

To operate the cigar punch, unscrew the swivel cap. With a clockwise twisting motion, cut into the cigar end making a clean hole. Pull back the cutter then press the ejector cap to clean out the cigar waste inside. Close up the key chain, light up and enjoy!

**Diagram C / Bushings #416 Sierra**

